



Mad River Valley Health Center

Mad River Valley Health Center, Inc.
P.O. Box 1990
Waitsfield, VT 05673
Phone: 802. 496-8911
info@mrvhc.com
www.MRVHC.com

BOARD MEMBERS

President

Sue Frechette

Vice-President

Chuck Martel

Treasurer

David Ellison

Secretary

Dara Torre

Directors

Suzanne Chamberlain

Connie Colman

Adam Greshin

Darren Misenko

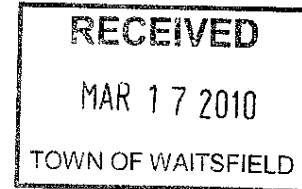

March 17, 2010

Waitsfield Selectboard
Waitsfield Town Office
9 Bridge Street
Waitsfield, VT 05673

To the Waitsfield Selectboard,

The Board of Directors of the Mad River Valley Health Center are pleased to be working with the Safe Routes to School team and the Town of Waitsfield on improving pedestrian access near the elementary school. Specifically, the board is in full support of creating a pedestrian walkway across our property to facilitate a crosswalk across Main Street/Route 100.

We've addressed questions or concerns from our tenants as well as our insurance company. We will continue to work with the SRTS team, the town, the region and state to determine the optimum path for the walkway. The only outstanding item at this point is the question of maintenance of the proposed walkway across our property. We would like to work with you to determine the best solution. Either the town could assume maintenance of the walkway, or we could add the walkway to our current maintenance contract and seek reimbursement for this expense. Our property manager estimates an incremental cost of \$600/year to keep the proposed walkway clear during the winter months.

I look forward to the next steps. If you have any questions, please contact me.

Thanks.

Sue Frechette

The mission of the Mad River Valley Health Center is to provide a quality facility to ensure the availability of local health care to residents of the Mad River Valley, neighboring communities and visitors

MAD RIVER VALLEY HEALTH CENTER

SITE PLAN - PROPOSED LOOP RD. CROSSWALK
SCALE 1"=40'
2-10

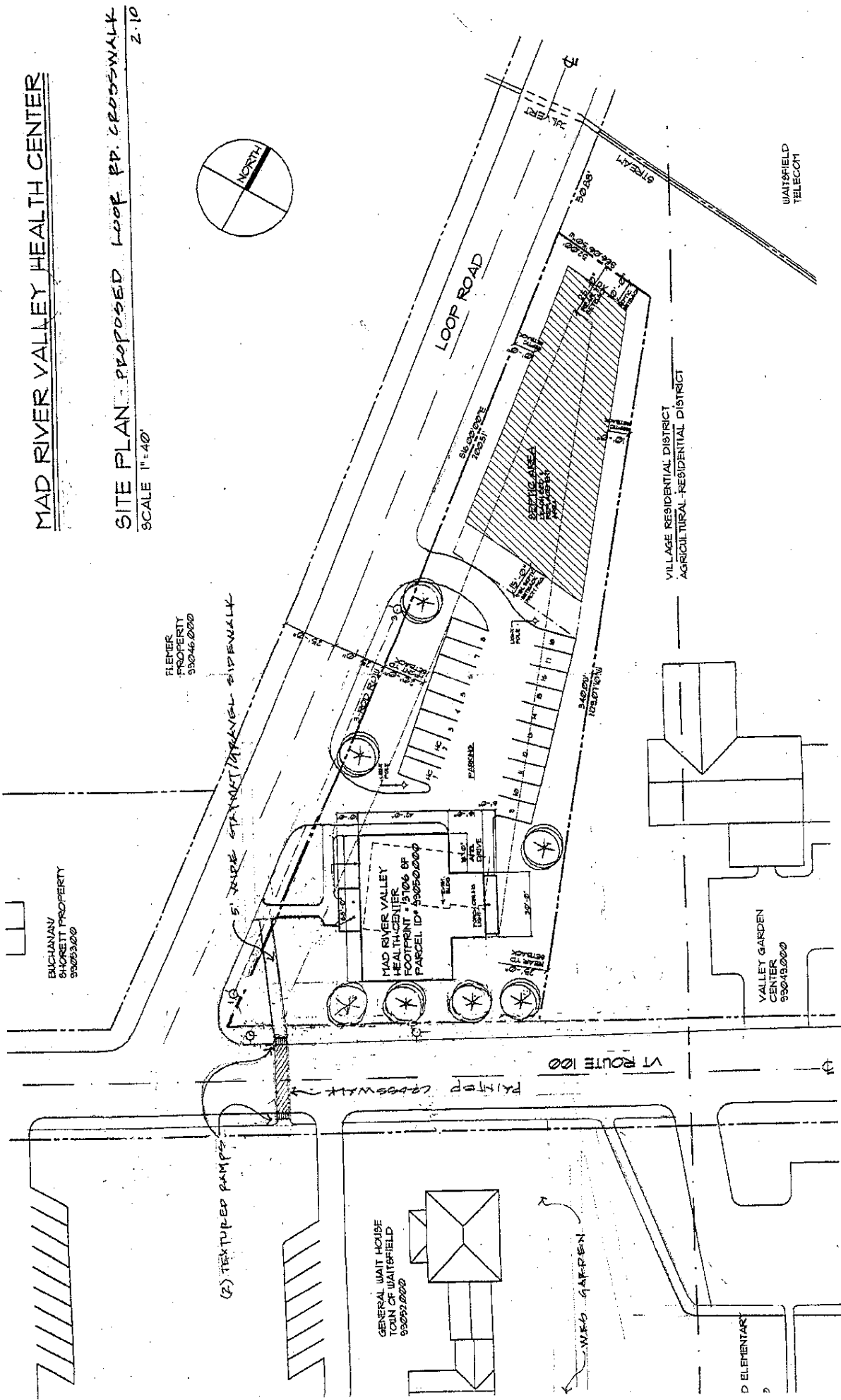
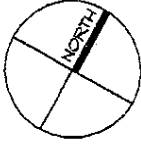

BUCHANAN/
SHORETT PROPERTY
95023.00

FLEVER
PROPERTY
95046.000

5' WIDE GRANITE TRAVEL SIDEWALK

MAD RIVER VALLEY
HEALTH CENTER
FOOTPRINT - 15,106 SF
PARCEL ID - 95050.000

GENERAL WAIT HOUSE
OWN. BY WAITFIELD
95053.000

VALLEY GARDEN
CENTER
95049.000

VILLAGE RESIDENTIAL DISTRICT
AGRICULTURAL-RESIDENTIAL DISTRICT

WAITFIELD
TELECOM

(2) TEXTURED RAMP

WATER GARDEN

D ELEMENTARY

VT ROUTE 100

PAVING CROSSWALK

LOOP ROAD

SEPTIC AREA

WATER MAIN

15 SPACES

15 SPACES

15 SPACES

15 SPACES

15 SPACES

15 SPACES

15 SPACES

15 SPACES